

# UNAIDED REBOARDING

## ⚠ WARNING

Rotating propeller may cause serious injury or death. Shut off engine when near persons in the water.

In the event that a passenger falls overboard, there are several ways to re-board a Walker Bay boat from the water. Some models are equipped with ladders to facilitate re-boarding, although some models may or may not have a ladder as a means of re-boarding, the boarding procedure is described below:

### Generation

#### Model 525

Go to the port side of the transom, turn the ladder back and remove the velcro that holds the steps, then slide them down so that they are ready for use. Use the handle on the deck to support yourself and step on the steps of the shower area to return to the boat.

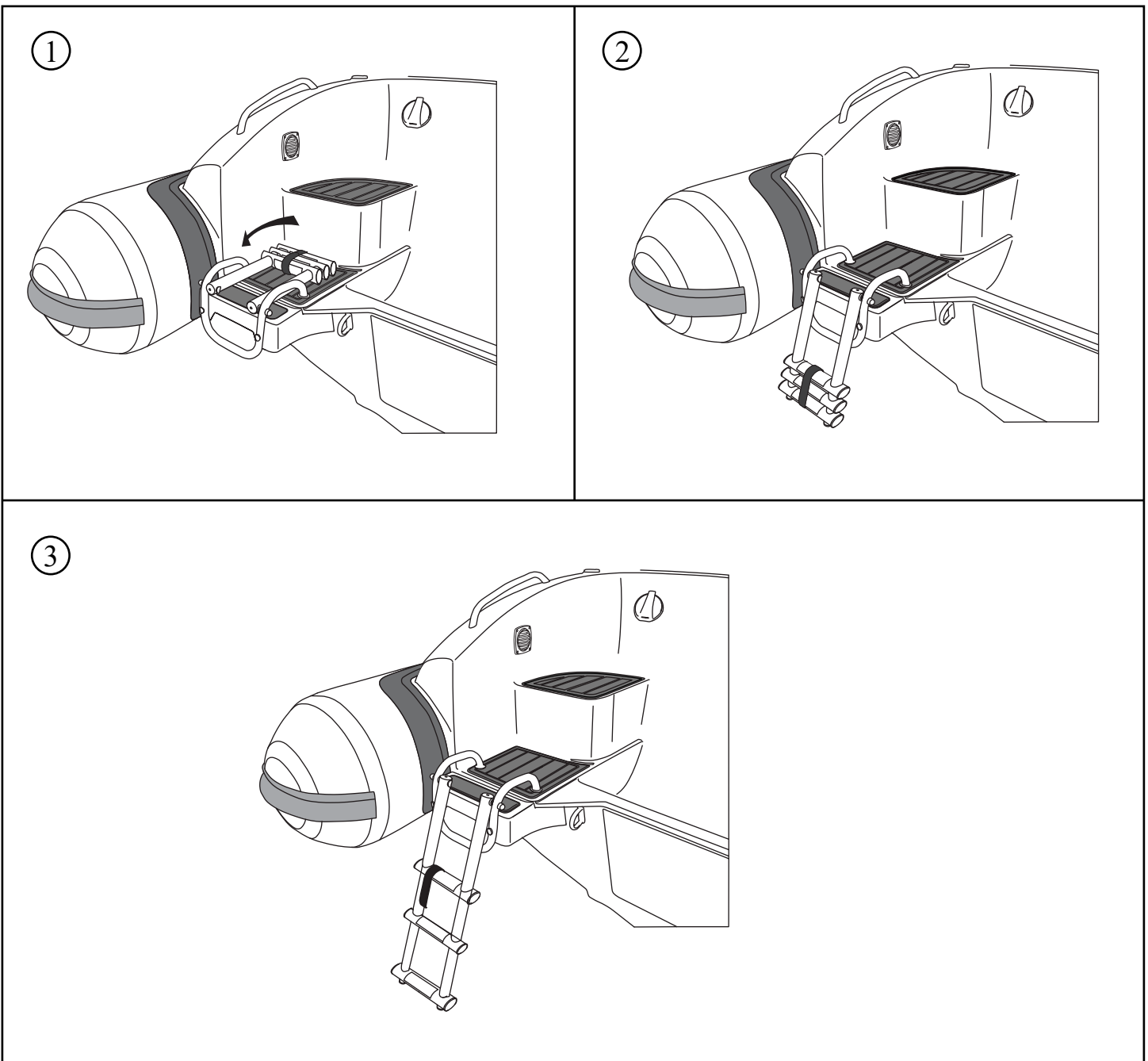

# UNAIDED REBOARDING

## WARNING

Rotating propeller may cause serious injury or death. Shut off engine when near persons in the water.

In the event that a passenger falls overboard, there are several ways to re-board a Walker Bay boat from the water. Some models are equipped with ladders to facilitate re-boarding, although some models may or may not have a ladder as a means of re-boarding, the boarding procedure is described below:

### Generation

Model 400 & 450

Go to the port side of the transom, take the ladder and pull it loose from the clamp, rotate it into position so that it is ready for use. Use the handle on the deck to hold on and step firmly on the steps of the deck to return to the boat.

①

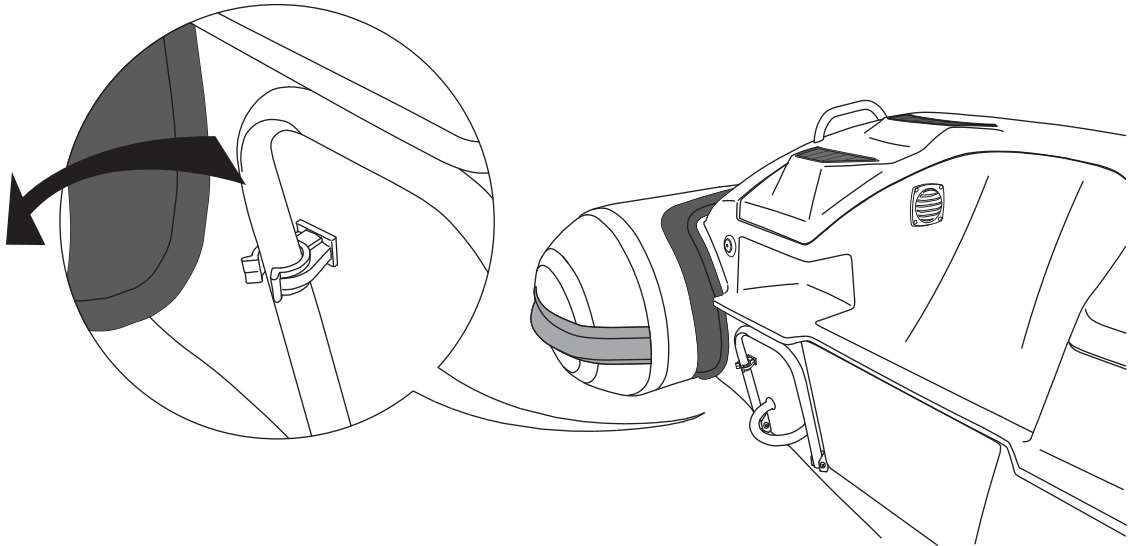

②

